



VASO^{STAT}[®]

H E M O S T A S I S D E V I C E

APPLICATION GUIDELINES



Clean and dry skin at sheath site.

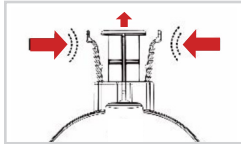

Squeeze wings of plunger together to remove from base

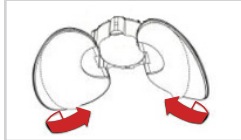

Peel paper from adhesive wings.



A

Attach base by pressing wings firmly onto skin (*Figure A*) while centered over artery entry site (*Figure B*).



B



Peel paper from separate adhesive pad. Attach pad first to the base and then gently stretch around patient anatomy and attach it to skin.

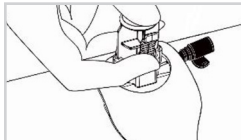

Insert plunger back into base. Depress plunger while stabilizing the base until plunger is applying gentle pressure onto skin.

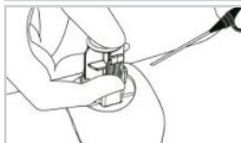

Remove sheath while applying 1-3 notches of additional pressure depending on patient anatomy.

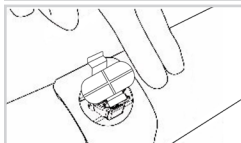

Check radial pulse to confirm patent hemostasis using standard technique, adjust plunger depth if needed.



Ensure site is dry. Allow time for hemostasis then follow removal guidelines.

Note: These guidelines are based on compilation of best practices, and they are not a replacement for the Instructions for Use (IFU). The IFU should be read in entirety before using the device.

